

INDOOR TANNING EQUIPMENT CARE, USE AND INSTALLATION INSTRUCTIONS

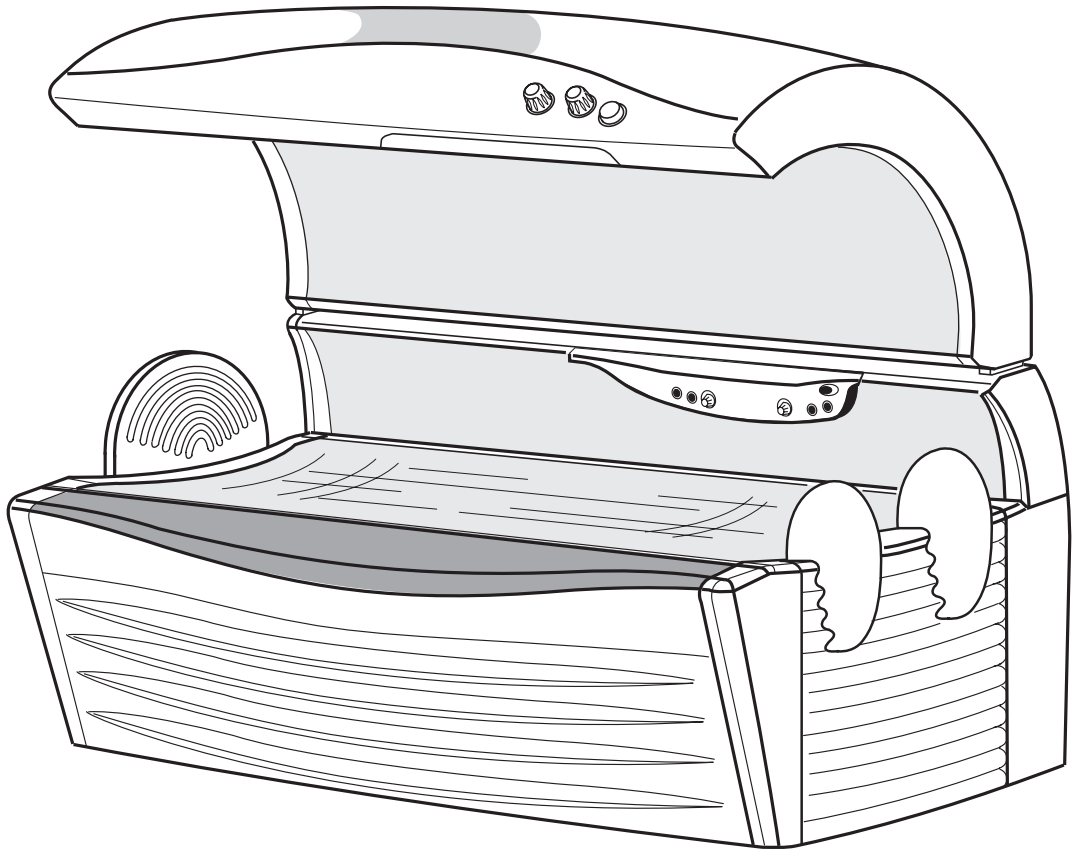

**Model:
SILVER BULLET**

**PC MARKETING
1040 WILT AVENUE
RIDGEFIELD, NJ 07657**



1-800-FAST TAN

Preface

Your unit has been built in accordance with the latest state of the art technology. Persons installing the unit, placing it into operation, operating, maintaining and repairing it must read and understand the operating instructions and especially the user safety instructions before the unit is used for the first time.

TABLE OF CONTENTS	PAGE
1 SAFETY INSTRUCTIONS	4-6
1.1 Before Initial Operation	4
1.2 Using the Unit for the First Time	4
1.3 Safety / Warnings	4-6
1.4 Proper Operation	6
1.5 Product Liability	6
1.6 Emergency Procedure	6
1.7 Explanation of Warning Symbols	6
1.8 Position of the User	6
 OPERATION INFORMATION FOR THE USER OF THE UNIT	
2 OPERATION	7-8
2.1 Equipment – Special Features	7
2.2 Start of Tanning	7
2.3 Interior Tanning Space	8
2.3.1 Interior Operating Panel	8
2.4 Cleaning the Acrylic Sheet	8
 INFORMATION FOR THE OPERATOR	
3 INITIAL OPERATION	8-9
3.1 Important information! PLEASE READ!	8-9
3.2 Before Initial Operation	9
3.3 Using the Unit for the First Time	9
 4 CLEANING - IMPORTANT INFORMATION FOR THE OPERATOR	9
 5 TECHNICAL DATA	10
5.1 Operating Hours	10
5.2 Warm Air Circulation	10
5.3 Factory Settings	10
5.4 Temperature Switch	10

MAINTENANCE AND REPAIR 11-17

6.1 Changing the Acrylic Sheet 11

6.1.1 Acrylic Sheet - Lounge 11

6.1.2 Acrylic Sheet – Side of Tanner 12

6.1.3 Acrylic Sheet - Canopy 12

6.2 Servicing the High-Pressure Lamps 12-13

6.2.1 Changing the High-Pressure Lamps in the Side Tanner 13

6.2.2 Changing the High-Pressure Lamps in the Canopy 14

6.2.3 Changing the High-Pressure Lamp in the Shoulder Tanner 15-16

6.3 Changing the Lamps 16

6.3.1 Changing the long Sun lamps 16

6.3.2 Changing the Illumination lamp 16

6.3.3 UWE LIGHT Logo in the Bed 16

6.4 Changing the Filter Pads 17

6.4.1 Filter pads in the Base Casing 17

6.4.2 Filter Pads in Canopy 17

6.5 Stay position in the Support Arms 17

7 GENERAL TROUBLESHOOTING GUIDE 18

8 DISPOSAL 18

TECHNICIAN’S SPECIFICATIONS

9 INSTALLING UNIT 19-27

9.1 Site and Delivery Location of Installation 19

9.2 Installation and Assembly 19

9.2.1 Disassembling the Lounge 19

9.2.2 Disassembling the Boards and Air Conditioning Unit 19-20

9.2.3 Disassembling the Side Tanner 20

9.2.4 Disassembling the Exhaust Unit 20

9.2.5 Disassembling the Casing 20

9.2.6 Disassembling the Canopy 20-21

9.2.7 Disassembling the Base 21

9.2.8 Installing the Exhaust Unit 21

9.2.9 Assembling the Base 21

9.3 Assembling the Casing 22

9.3.1 Assembling the Boards and Air Conditioning Unit 22

9.3.2 Assembling the Canopy 23-24

9.3.3 Assembling the Side Tanner 24

9.3.4 Mounting the Covering Panels in the Canopy, Louvre and Exhaust Unit 24

9.3.5 Connecting the Plug-In Connections 24

9.3.6 Assembling the Lounge 24-25

9.4 Connecting the Exhaust 25

9.5 Electrical Connection 25

9.6 Remote Timer Control 26

10 INITIAL OPERATION 26-27

10.1 Technical Specifications, Dimensions and Lamp Configuration 26-27

11 CUSTOMER SERVICE ADDRESS 27

PICTURES

Picture 1- 13 29

Picture 14 - 26 30

Picture 28 - 36 31

1 SAFETY INSTRUCTIONS:

1.1 Before installation and placing in operation, the Safety Instructions and Operating Instructions must be carefully read and observed.

1.2 Before the unit is placed in operation, the local Safety Regulations and the Safety Instructions must be complied with.

1.3 SAFETY / WARNING



Warning

DANGER – ULTRAVIOLET RADIATION

Follow instructions. Avoid overexposure. As with natural sunlight, overexposure can cause eye and skin injury and allergic reactions. Repeated exposure may cause premature aging of the skin and skin cancer. Consult physician before using sunlamp if you are using medication or have a history of skin problems or believe yourself especially sensitive to sunlight. If you do not tan in the sun, you are likely to tan from the use of this product.

WEAR PROTECTIVE EYEWEAR: FAILURE TO MAY RESULT IN SEVERE BURNS OR LONG – TERM INJURY TO THE EYES.

THIS UNIT UTILIZES UVA LAMPS.

CAUTION REPLACE ONLY WITH:

COSMOLUX 160W VHR CANOPY/LOUNGE

800WP/N BQ 880 Z4 ,CANOPY

400W P/N BQ 471Z4, CANOPY AND SHOULDER TANNERS

OR FDA APPROVED EQUIVALENT

For proper lamp placement, please refer to technical specifications 10.1in table of contents.

Therefore, you must observe the following Safety Instructions:

The ultraviolet and visible radiation is very intense. DO NOT stare at the tanning lamps. While tanning, close your eyes, and always use the protective eyewear that is supplied.

Before tanning, always remove jewelry.

DO NOT tan more frequent than once every two days.

For recommendations about exposure times and recommended frequencies, please see below

SCHEDULE FOR LAMPS TYPE: SEE LAMPS PAGE 12 AT 12 MIN.-TIMER

RECOMMENDED EXPOSURE SCHEDULE	Skin Type	WEEK 1 1 st – 3 rd Session	WEEK 2 4 th – 6 th Session	WEEK 3 7 th – 8 th Session	WEEK 4 11 th – 15 th Session	WEEKLY Subsequent Session
	II – Fair	2 min.	6 min.	9 min.	12 min.	12 min.
	III – Average	3 min.	6 min.	10 min.	12 min.	12 min.
	IV – Brown	3 min.	7 min.	10 min.	12 min.	12 min.
	V – Dark Brown	3 min.	7 min.	10 min.	12 min.	12 min.

SCHEDULE FOR LAMPS TYPE: SEE LAMPS PAGE 12 AT 15 MIN.-TIMER

RECOMMENDED EXPOSURE SCHEDULE	Skin Type	WEEK 1 1 st – 3 rd Session	WEEK 2 4 th – 6 th Session	WEEK 3 7 th – 8 th Session	WEEK 4 11 th – 15 th Session	WEEKLY Subsequent Session
	II – Fair	3 min.	5 min.	9 min.	15 min.	15 min.
	III – Average	5 min.	6 min.	9 min.	15 min.	15 min.
	IV – Brown	5 min.	8 min.	11 min.	15 min.	15 min.
	V – Dark Brown	5 min.	8 min.	11 min.	15 min.	15 min.

Tanning can begin on a regular basis (allowing 48 hours between sessions). An appearance of tanning normally occurs after a few exposures and maximizes after four (4) weeks of exposure following the recommended exposure schedule of two (2) weekly 12 minute sessions is recommended from the fifth week onward.

USE PROTECTIVE EYEWEAR WHENEVER THE EQUIPMENT IS ENERGIZED. READ THE INSTRUCTION BOOKLET BEFORE USING THIS PRODUCT.



Warning

WARNING

If you have been diagnosed by a physician as being allergic to the sun or are currently taking photosensitive medications, consult your physician before using this product.

Children, persons with fair skin, elderly persons and persons who have a history of skin problems or believe yourself especially sensitive to sunlight, should avoid using this product. If you do not tan in the sun, you are likely to tan from this product.

Certain drugs – particularly those designed to enhance photosensitivity – maybe cause individuals under their influence to experience adverse effects and those people ought to avoid exposure to UV sources of all kinds. Doctors will advise persons taking these drugs of possible adverse effects.

It is recommended that only one person at a time use the tanning system. Use protective eyewear while tanning. One pair of protective eyewear is provided with each unit sold.

Occasionally, persons, using the tanning system will experience a slight reddening of the skin – usually in small patches – after the second or third session. This redness is often accompanied by an itching sensation. This is nothing more than a heat "rash" caused by heat from the lamps within the system. It is generally very limited. It will go away within approximately 24 hours and should not reappear. This rash can be lessened or prevented by applying moisturising lotion to the affected area after the tanning session is complete.



Warning

CAUTION:

WHILE THERE IS NO IMMEDIATE CLINICAL EVIDENCE REGARDING UV EXPOSURE AND ITS EFFECTS UPON EXPECTANT MOTHERS, IT IS STRONGLY ADVISED THAT EXPECTANT MOTHERS BE DISCOURAGED FROM USING THIS PRODUCT.

EXPOSURE TIMES AND FREQUENCIES

Melanin, the brownish pigment produced by special cells in the base layers of the skin determines the individual ability to tan. As the skin is exposed to ultraviolet rays, the melanin is activated and combines with protein cells that rise to the skin's surface, thus producing a tan. The amount of melanin in your body determining how quickly and darkly you can tan.



Function

NOTE

THE TAN PRODUCED BY THIS UNIT IS A DEEP, RICH "COSMEDIC" TAN, HOWEVER, REGARDLESS OF HOW MUCH AN INDIVIDUAL MAY TAN WITH THIS UNIT, IT WILL NOT PROVIDE ADEQUATE PROTECTION AGAINST OVEREXPOSURE TO NATURAL SUNLIGHT OR UVB TANNING SYSTEMS.

- SKIN TYPE II - THIS IS THE INDIVIDUAL THAT USUALLY BURNS EASILY AND SEVERELY. TANS MINIMALLY OR LIGHTLY AND PEELS.
- SKIN TYPE III - OFTEN REFERRED TO AS "AVERAGE" COMPLEXION. BURNS MODERATELY AND TANS ABOUT AVERAGE.
- SKIN TYPE IV - THIS INDIVIDUAL BURNS MINIMALLY, TANS EASILY AND ABOVE AVERAGE WITH EACH EXPOSURE.
- SKIN TYPE V - THIS INDIVIDUAL RARELY BURNS, TANS EASILY

SCHEDULE FOR LAMPS TYPE: SEE LAMPS PAGE 12 AT 12 MIN.-TIMER

RECOMMENDED EXPOSURE SCHEDULE	Skin Type	WEEK 1 1 st – 3 rd Session	WEEK 2 4 th – 6 th Session	WEEK 3 7 th – 8 th Session	WEEK 4 11 th – 15 th Session	WEEKLY Subsequent Session
	II – Fair	2 min.	6 min.	9 min.	12 min.	12 min.
	III – Average	3 min.	6 min.	10 min.	12 min.	12 min.
	IV – Brown	3 min.	7 min.	10 min.	12 min.	12 min.
	V – Dark Brown	3 min.	7 min.	10 min.	12 min.	12 min.

SCHEDULE FOR LAMPS TYPE: SEE LAMPS PAGE 12 AT 15 MIN.-TIMER

RECOMMENDED EXPOSURE SCHEDULE	Skin Type	WEEK 1 1 st – 3 rd Session	WEEK 2 4 th – 6 th Session	WEEK 3 7 th – 8 th Session	WEEK 4 11 th – 15 th Session	WEEKLY Subsequent Session
	II – Fair	3 min.	5 min.	9 min.	15 min.	15 min.
	III – Average	5 min.	6 min.	9 min.	15 min.	15 min.
	IV – Brown	5 min.	8 min.	11 min.	15 min.	15 min.
	V – Dark Brown	5 min.	8 min.	11 min.	15 min.	15 min. .

No two individual skin tones are the same. A tan to one person may be different to another, and session length may vary. It is recommended that, following a tanning session, a skin moisturiser be applied. This promotes a smoother more even looking tan. Equally important – many facial make-ups have oil bases and should be removed prior to each tanning session.

NOTE

SINCE THE BACK AND STOMACH AREAS OF THE BODY WILL RECEIVE THE MAJORITY OF THE TANNING RAYS, IT IS RECOMMENDED THAT INDIVIDUALS SPEND ONE HALF OF EACH SESSION LYING ON EACH SIDE OF THE BODY TO ACHIEVE A FULL-BODIED TAN.

WARNING

COMMERCIALY AVAILABLE CREAMS, LOTIONS AND OILS CONTAIN SUNSCREENS WHICH FORM A PHYSICAL BARRIER ON THE SKIN THAT PREVENTS THE UV RAYS FROM PENETRATING AND INDUCING A TAN. IT IS RECOMMENDED THAT YOU ONLY USE CREAMS, OILS OR LOTIONS THAT **DO NOT CONTAIN POLYTHENE/GLYCOL MONOLAURATE** AND ARE DESIGNED FOR USE WITH INDOOR TANNING EQUIPMENT. FAILURE TO COMPLY WITH RECOMMENDATIONS AND WARNINGS STATED ABOVE MAY VOID THE MANUFACTURER'S WARRANTY.

WARNING!

THIS UNIT **MUST NOT** BE USED IF THE TIMER IS FAULTY OR IF THE FILTER GLASS PLATE IS BROKEN.

1.4 Proper Operation

All units are intended solely for tanning in the interior of buildings. Operate the unit only in places where there is no risk of hazards and only in dry rooms. The rooms must be well-ventilated (adequate air inflow and air outflow). If the unit is operated in a tanning salon, extremely strict hygiene must be ensured both on the unit and in the room. Any type of use not complying with these remarks is improper, and the manufacturer will not accept liability for any resulting damage or injury. Proper operation also includes compliance with the operating, maintenance and repair conditions specified by the manufacturer. Qualified service technicians authorized by PC Marketing, Inc should only perform maintenance work, and repair work. If unauthorized modifications are made on the units, the manufacturer will not accept liability for any resulting damage or injury.

1.5 Product Liability

The unit may only be operated in the proper manner. If it is operated in an improper manner, the user assumes sole responsibility. In such cases, the manufacturer cannot accept any liability.

1.6 Emergency Procedure

Switch off the electrical supply to the unit by operating the main power switch or circuit breakers, and source the unit to prevent it from being switched on again without authorization.



Warning

1.7 Explanation of Danger Symbols

Warning!

In these Operating Instructions, we have used the word **warning** to mark all concerns that relate to operating safety. Please post safety instructions for all users.



Function

In these Operating Instructions, we have used the word **note** to mark all concerns, which contain essential information for operating the unit. Please be sure they are followed in order to avoid damage to the unit.

Note Various diagrams are referred to in the text, i.e....(30/2) refers to figure 30, item 2.

1.8 Location of the Person Using the Unit

In front of the unit and on the unit's lounge acrylic for tanning.

OPERATION INFORMATION FOR THE USER OF THE UNIT



Function

2 OPERATION

2.1 Equipment – Special Features

Important Information! PLEASE READ!

1. Please inform each user of this information before using the unit.

HIGH-PRESSURE SHOULDER TANNERS

The unit is equipped with two high-pressure shoulder tanners.

AIR SHOWER

There is an air vent in the canopy, which allows cool air to pass directly over the upper body.

HEADPHONES SOCKET

Plug in access socket of a 3.5 mm headphone jack to enjoy the central sound system.

LOUDSPEAKER

The unit is equipped with two speakers allowing you to enjoy the music from the central sound system while you tan.

FANS

The fans are factory-set to continue running for approx. 6 minutes after the tanning session to allow the unit to cool.

BREAKSAFE

The filter glass plates for high-pressure lamps in the canopy and side tanner, and the transparent filter glass plates in the shoulder tanners are protected by a BREAKSAFE device. If one of these filter glass breaks, the power supply is interrupted and the unit cannot be restarted. The blue filter glass plates in the shoulder tanner must be visually checked.

BINGO

The BINGO feature (additional exposure time for face tanning) is not implemented in models for USA and Canada due to FDA/CSA regulations.

WARM AIR RECIRCULATION

When the room reaches the appropriate temperature, warm air is blown into the unit via a thermostat-controlled extract air flap in the extract air chimney maintaining a comfortable tanning environment.

2.2 START OF TANNING

Observe the recommended exposure chart.

Do not exceed the tanning time recommended for your skin type.

You may stop the tanning session at any time by means of the STOP button on the operating panel. When the unit is started, the initial delay period begins. The unit starts automatically after the end of the initial delay. The unit can be restarted (providing there is time remaining on the central remote timer) by means of the START button.



Warning

MAKING USE OF THE PRE – START DELAY TIME

1. Make your selections.
 - Use the right knob (1/3) to select your personal tanning level
 - Use the left knob (1/2) to select your personal air-conditioning level
 - The BINGO button (1/4) has no function.
2. If you do not make any selections the unit will automatically start with its basic settings.

Tanning level for body and face	Level 5
- Air-conditioning levels for body and face	Level 3
- Volume	Central setting

The tanning program you have chosen will appear on the display (1/1).

You can change your chosen tanning program at any time during the tanning session. Operate the interior-operating panel from the bed. If you do not switch on the unit within 5 minutes the programme will revert to the basic settings.

The unit switches on automatically after the pre-start delay time depending on the remote timer operation.



Warning

2.3 INTERIOR TANNING SPACE

1. Lie down on the lounge.

Keep your body away from the front edge of the bed. Danger of squeezing!

2. Pull down the canopy with the handle (1/6) you can reach with your left hand.

Note

Your distance from the lamps is determined by the design of the unit. If the tanning session has not yet begun, the pre-start delay time is still active. The lamps switch on automatically after the pre-start delay time.



Warning

2.3.1 Interior Operating Panel

You can interrupt the tanning session at any time by pressing the STOP button (2/2).

- **STOP and START Buttons**

During the tanning session you can press the STOP button (2/2) to interrupt tanning and the START button (2/1) to re-start tanning (Warning: the high-pressure lamps only re-ignite after a cooling time of approx. 4 minutes). The tanning time continues during the interruption, i.e. the display (2/9) continues to count the minutes elapsed.

- **Cooling Control Knobs**

You can control the desired climate by knob (2/3) which controls the cool air inflow from the fan at the base of the unit and cool air inflow from the vent at the top of the canopy. The blue LED lamps light up according to the air conditioning you have selected.

- **Tanning Intensity Control Knob**

Knob (2/6) allow you to control the tanning intensity on your body and face tanning lamps. Lamps are turned on depending on the position of the knob. The red LED lamps light up according to the tanning level you choose.

- **Volume Buttons**

Buttons (2/10) and (2/11) allow you to control the volume of the music played on the central sound system.

- **LED Display**

The 2-digit LED display (2/9) counts the time of the tanning session in intervals of 1 minute once the sunlamps are switched on, showing you how many minutes of your tanning session have elapsed. After the tanning session is complete the unit switches off and the display shows 0.

2.4 Cleaning the Acrylic Sheets: Use PC Marketing's Hygiene/Acrylic Cleaner

The bed (5/1) must be disinfected and cleaned after every tanning session.

Ensure extremely strict hygiene on the tanning unit and in its vicinity. Dust deposits reduce the tanning effect. Do not pour liquids over the unit so as to avoid moisture penetrating under the covers and onto the electronics. Use cleaners in accordance with the instructions. Follow the recommended waiting time for acrylic cleaners as per manufacturer's instructions.



Warning

Cleaning the Acrylic Sheet

1. Clean the acrylic sheets after every tanning session with PC Marketing's Hygienic Acrylic cleaner or approved equal.
2. Always dry the panel afterwards with a clean cloth.

INFORMATION FOR THE OPERATOR

3 Initial Operation

3.1 Important information! PLEASE READ!

Instructions to operator:

Do not place any malfunctioning equipment into operation.

Observe the maximum permissible room temperature (95°F), otherwise there's the danger that the acrylic area to lie on gets too hot.

Disinfect the acrylic shield with UVT (UltraViolet Transmitting) acrylic cleanser by PC Marketing.

Provide protective eyewear and require their use during tanning.

Observe and follow recommended exposure schedule, which list skin types, exposure times and frequencies.

Keep operating instructions available at all times.

Display the safety instructions in a clearly visible position.



Warning

There is a sticker on the acrylic panel of the bed providing important information in 4 languages. Please read this information and then remove the sticker.
Never operate the unit for long periods of time with the canopy open.

3.2 Before Initial Operation

Before installation and placing in operation, the Safety Instructions and Operating Instructions must be carefully read and observed.

3.3 Using the Unit for the First Time

Note Before the unit is placed in operation, the local safety Instructions must always be observed. When the unit is completely installed, electrically connected and connected to the remote timing system, it can be in operation.

4 CLEANING - IMPORTANT INFORMATION FOR THE OPERATOR

Ensure extremely strict hygiene on the tanning unit and in its vicinity. Dust deposits reduce the tanning effect. Do not pour liquids over the unit so as to avoid moisture penetrating under the covers and onto the electronics. Use cleaners in accordance with the instructions. Follow the recommended waiting time for acrylic cleaners as per manufacturer's instructions.

- **Frame**

Clean the painted external surfaces of the unit with a slightly damp cloth; some detergent can be added to the water. Do not use abrasive materials. Stubborn dirt can be removed with a soft cloth and a biodegradable cleaning material.

- **Acrylic Sheet**

Use only the genuine PC Marketing acrylic cleaner or approved equal. If cleaning materials other than these are used, we cannot accept any warranty liability. Occasionally, also clean the side of the acrylic sheet facing the lamps. To do this, take the acrylic sheet off.

- **Reflector**

When changing the lamps, clean the reflectors with a cloth soaked with alcohol.

Cleaning the Acrylic Sheets

1. Only use the PC Marketing acrylic cleaner or approved equal.
2. Follow the manufacturer's instructions for waiting period
3. Always dry the acrylic afterwards with a clean cloth.
4. Occasionally clean the underside of the lounge, the waved formed acrylic sheet beneath the lounge and the acrylic sheet in the canopy.

Lifting the Lounge Acrylic Sheet

The rear, long side of the lounge sheet is inserted in a clamping rail which can be pulled forwards about 2 inches on 2 pins.

1. Use a screwdriver.
2. Press the bolt (3/2) down and turn 90 degrees.
3. Do the same with the second bolt. The bed panel moves up a little.
4. Holding the lounge acrylic (3/1) along the front long side, pull approx. 2 inches forwards until the clamping rail (3/3) engages.
5. Lift up the lounge acrylic.
6. Take the long rod (4/3) and use it to support the lounge acrylic in the center.
7. Lift the lower acrylic sheet (4/2) and support it with the shorter rod (4/4).
8. Anchor this shorter rod in the first (bottom) acrylic sheet.
9. Clean the underneath of the bed panel and the lower acrylic sheet with PC Marketing acrylic cleaner or approved equal.

Lowering the Acrylic Sheet

1. Secure the short rod (4/4) in the holder.
2. Lower the lower acrylic sheet.
3. Secure the long rod (4/3) in the holder.
4. Lower the lounge acrylic.
5. Turn both bolts (3/2) back 90 degrees.
6. Grip the front long side of the lounge acrylic (3/1) and push backwards until it engages.

- **Reflector**

1. When replacing lamps, wipe the reflectors with a cloth which has been soaked in alcohol.

5 TECHNICAL DATA

5.1 Operating Hours

5.2 Viewing the Operating Hours

The operating hours can be viewed on the display of the interior operating panel.



Warning

The unit must be off (no remote timer signal).

1. Simultaneously press 4 buttons on the interior operating panel: START button (2/1), STOP button (2/2) and the 2 buttons used to control the volume (2/10) and (2/11).
2. Press this button combination for about 4 seconds. The two first figures (thousands and hundreds) of the operating hours are displayed.
3. Press the + volume button (2/10). The tenths for the operating hours are then displayed.
4. If you do not press any buttons, the operating hours indicator is deactivated after 5 second.



Warning

The various levels of the warm air re-circulation can be set at the display of the Interior Operating Panel

The unit must be off (no remote timer signal).

• Setting the Warm Air Re-circulation

The operator can close (max.) or open (min.) the air vent in the exhaust duct or select a temperature for inside the unit.

1. Simultaneously press 4 buttons on the interior operating panel: START button (2/1), STOP button (2/2) and both buttons for volume control (2/10 and 2/11).
2. HOLD this button combination for about 4 seconds. The operating hours are shown on the interior operating display panel (2/9)
3. Turn the left knob on the interior operating panel (air-conditioning). The numbers 1 to 6 appear on the display (2/9).
4. Select the air conditioning level you require (table 1).
5. When you have chosen the level, the display for the warm air re-circulation goes out after 5 seconds and the operating hours indicator after another 5 seconds.



Warning

Unplug the unit from the main power supply to save the changed parameters.

Warm Air Recirculation can be selected by operator	Exhaust air flap position	Effects
Limit stop min. = Level 1	open	No warm air inside unit. Warm air in exhaust duct
Level 2 (62°F-65°F) Level 3 (65°F-67°F) Level 4 (67°F-69°F) Level 5 (69°F-72°F) Level 6 (75°F)	Flap open	The flap setting maintains the temperature inside the unit to your set level
The temperatures indicated are for guidance only due to the differences in temperature in the room and are only used as a reference		

Table 1

5.3 Factory Settings

The main processor board is equipped with a potentiometer for adjusting the after running time of the fan.

1. Using a screwdriver, turn the potentiometer to the period of time you require.

5.4 Temperature Switch

The temperature switch on the IGB housing reacts if a failure occurs with the GB fan (right-hand side of base casing). The temperature switch can be turned back on again.



Warning

6 MAINTENANCE AND REPAIR

Always unplug the unit from the main power source!

The owner/operator must ensure that the unit is always operated in perfect condition.

Ensure the technical equipment is serviced and checked regularly.

Only authorized technicians may work on the unit, please contact PC Marketing or your authorized dealer.

Do not use work procedures which impair the safety of the unit.

Always obtain original replacement parts from an authorized dealer or PC Marketing.

Liability cannot be assumed if other lamps or parts are installed other than original.

Do not operate the unit without the acrylics in place.

When working on the canopy the large covering panel (31/2) can be supported on a bar (31/1), i.e. the covering panel need not be removed completely.

The canopy is secured by a stay.

6.1 Changing the Acrylic Sheet

The acrylic sheets are produced and formulated from specially treated acrylic material highly transparent to UV light. The process of forming and molding the acrylic sheets is done within an exact temperature controlled environment. Finally, the acrylics are annealed (oven baked) for longevity. This strict process of manufacturing can have no deviation.

Therefore, when replacing acrylic sheets, please be aware that all suppliers DO NOT manufacture acrylic sheets the same. To be sure you are receiving genuine replacement acrylic sheets, contact PC Marketing.

When a replacement is delivered, the acrylic sheet is covered with a protective covering on both sides. Before installing in the tanning bed, pull off the protective covering. DO NOT operate the unit without acrylic sheets in place, as the cooling of the lamps cannot be assured.

If damage or injury occurs, the manufacturer cannot accept liability.

The acrylic sheet of the canopy and side tanner and the lounge sheet are frosted on one side.

1. During installation ensure that the frosted side of the acrylic sheet always faces the lamps.
2. DO NOT polish the frosted side of the acrylic sheet with polish.

6.1.1 Acrylic Sheet Lounge

Note There are 2 acrylic sheets on top of one another in the lounge. The back long side of the upper lounge sheet (acrylic) is inserted in a clamping rail which can be moved forward approx. 2 inches on 2 castors.

Removing the Acrylic Sheets

1. With a screwdriver.
2. Using the screwdriver, press the bolt (3/2) down and turn 90 degrees.
3. Do the same with the second bolt. The lounge acrylic can move up a little.
4. Hold the lounge acrylic (3/1) along the front long side.
5. Pull the lounge acrylic and clamping rail (8/2) forward approx. 2 inches until the clamping rail engages with its pins (8/3).
6. Remove the lounge acrylic and clamping rail.
7. Remove the waved acrylic sheet below the lounge acrylic.

Replacing the Acrylic Sheets

1. Insert the lower acrylic sheet (corrugated) in the lounge.

The wide recesses in the corrugated acrylic sheet should be at the bottom of the lounge.

2. Hook the lounge acrylic with the pins (8/3) on the clamping rail (8/2) into the fixture (8/4).
3. Place the lounge acrylic on the lounge.
4. Turn both bolts (3/2) back 90 degrees.
5. Push the lounge acrylic back until it engages.



Warning

6.1.2 Acrylic Sheet Side Tanner

Removing the Acrylic Sheet

1. Lift up the operating panel (8/1).
The operating panel locks in position.
2. Turn the slots in the 3 bolts (6/1) horizontal.
3. Tilt the acrylic sheet (6/2) forwards onto the long side.
4. Lift the acrylic sheet out of the rail's groove (6/3).

Replacing the Acrylic Sheet

1. Lift up the operating panel (8/1).
The operating panel locks in position.
2. Lift the acrylic sheet according to the screen printing.
3. Insert the acrylic sheet (6/2) into the rail's groove (6/3).
4. Move the acrylic sheet back against the side tanner.
5. Turn the 3 bolts (6/1) to the vertical position.
6. Lower the operating panel (8/1).
The operating panel locks in position.

6.1.3 Acrylic Sheet of Canopy

Removing the Acrylic Sheet

1. Turn the slots in the 4 bolts (7/1) horizontal.
2. Tilt the acrylic sheet (7/2) forwards.
3. Lift the acrylic sheet out of the rail's groove (7/3).

Replacing the Acrylic Sheet

1. Position the acrylic sheet in the rail's groove (7/3) according to the screen printing.
2. Tilt the acrylic sheet (7/2) towards the canopy.
3. Turn the 4 bolts (7/1) to the vertical position.

RELAMPING INSTRUCTIONS

REPLACEMENT LAMP TYPES

CAUTION: REPLACE ONLY WITH ORIGINAL LAMPS OR FDA APPROVED EQUIVALENT

	12 Min. Timer	15 Min. Timer
CANOPY:	COSMEDICO COSMOLUX VHR NA1-15 160 W (NO. 16 150) HEREAUS NOBLELIGHT BQ 471 Z4 (PART NO. 45 006 328) HEREAUS NOBLELIGHT BQ 880 Z4 (PART NO. 45 006 169)	COSMEDICO COSMOLUX VHO 160 W (COS. NO. 16 161) HEREAUS NOBLELIGHT BQ 471 Z4 (PART NO. 45 006 328) HEREAUS NOBLELIGHT BQ 880 Z4 (PART NO. 45 006 169)
LOUNGE:	COSMEDICO - COSMOLUX VHR NA1-15-160 W	COSMEDICO - COSMOLUX VHO 160 W (COS. NO. 16 161)
SIDE TANNER:	COSMEDICO - COSMOLUX VHR NA1-15-160 W HEREAUS NOBLELIGHT BQ 471 Z4 (PART NO. 45 006 328)	COSMEDICO - COSMOLUX VHO 160 W (COS. NO. 16 161) HEREAUS NOBLELIGHT BQ 471 Z4 (PART NO. 45 006 328)
SHOULDER TANNER:	HEREAUS NOBLELIGHT BQ 471 Z4 (PART NO. 45 006 328)	HEREAUS NOBLELIGHT BQ 471 Z4 (PART NO. 45 006 328)

6.2 Servicing the High-Pressure lamps

The high-pressure lamps must only be used with the filter glass plates. If the filter is damaged or missing the unit must not be operated. Danger of burning!

If the face tanner is switched on again right away, it will either not ignite immediately or will not produce full power as it requires a 4-minute cooling off cycle.

When replacing the high-pressure lamp, please contact PC Marketing or your dealer. No liability can be accepted if others than new original lamps are installed.

BREAKSAFE

The filter glass plates for high pressure lamps in the canopy /side tanner, and the transparent glass of the shoulder tanners are protected by a BREAKSAFE device. Should one of these filters break, the power supply is interrupted and the unit can only be restarted when the filter glass has been replaced with a new one.



6.2.1 Changing the High-Pressure Lamp in the Side Tanner

Warning!

Hold the high-pressure lamp by the rectangular base (10/1) only.

Never pull the high-pressure lamp by the glass bulb.

Never touch the glass bulb of the high-pressure lamp with your fingers.

If you touch the glass bulb by accident, wipe off the finger prints with a clean cloth soaked in alcohol.

Removing the Acrylic Sheet

1. Lift up the operating panel (8/1). The operating panel locks in position.
2. Turn the slots in the 3 bolts (6/1) horizontal.
3. Tilt the acrylic sheet forwards onto its long side (6/2).
4. Lift the acrylic sheet out of the lower rail's groove (6/3).

Removing the High-Pressure Lamp

1. Slacken the 4 screws M6 x 10 (9/5) and remove the whole case (9/6) with the filter glass plates.
2. Holding the high-pressure lamp (10/2) by the rectangular base (10/1), push it lengthways into the holder (10/3) on one side until it is free on the other side.
3. Remove the lamp by pulling down.

Cleaning the Reflector

1. Clean the reflector (10/4) with a clean cloth soaked in alcohol.

Replacing the High-Pressure Lamp

1. Hold the new high-pressure lamp (10/2) by the base (10/1).
2. Insert the lamp (10/2) into the holder (10/3).
3. Press the holder back.
4. Insert the lamp.

Removing the Filter Glass plates

1. Remove the case (9/6) with the filter glass plates.
2. Unscrew both cheese head screws M 4 (9/1) and remove the covering plate (9/2).
3. Remove the filter glass (9/4).

Cleaning the Filter Glass plates

1. Clean the filter plate (9/4) with warm water. A little detergent may be added to the water.
2. Dry the filter plates with a clean cloth.



Function

The side tanner must not be used without the filter glass plate!

1. Insert the cleaned filter glass plates.
2. Refit the covering plate (9/2) with the screws (9/1).
3. Secure the completely assembled case (9/6) with cleaned filters using the screws M6 x 10 (9/5).



Function

The lug of the microswitch for the BREAKSAFE device is pressed back as you do this.

Replacing the Acrylic Sheet

1. Lift up the interior operating panel (8/1).
2. The interior operating panel locks in position.
3. Position the acrylic sheet in the rail's groove (6/3) according to the screen printing.
4. Move the acrylic sheet back against the side tanner.
5. Turn the 3 bolts (6/1) to the vertical position.
6. Lower the interior operating panel (8/1).
The interior operating panel locks in position.



Warning

6.2.2 Changing the High-Pressure Lamps in the Canopy

Warning!

Hold the high-pressure lamp by the rectangular base (12/2) only.

Never pull the high-pressure lamp by the glass bulb.

Never touch the glass bulb of the high-pressure lamp with your fingers.

If you touch the glass bulb by accident, wipe off the finger prints with a clean cloth soaked in alcohol.

Removing the Acrylic Sheet

1. Turn the slots in the 4 bolts (7/1) horizontal.
2. Tilt the acrylic sheet (7/2) forwards onto the long side.
3. Lift the acrylic sheet out of the lower rail's groove (7/3).

Removing the High-Pressure Lamp

1. Choose the appropriate side. The high-pressure lamps in the canopy are located under the glass holders which can be swivelled against one another.
2. Slacken both screws M 6 x 10 (11/2).
3. Hold the disc holder (12/6) with both hands and swivel it towards the canopy holder.
4. Unhook the disc holder (12/6) from the hook (12/5).
5. Hold the high-pressure lamp (12/3) by the rectangular base (12/2)
6. Push the lamp longitudinally into the socket (12/1) until the other side becomes free.
7. Remove the lamp.

Cleaning the Reflector

1. Clean the reflector (12/4) with a clean cloth soaked in alcohol.

Replacing the High-Pressure Lamp

1. Hold the new high-pressure lamp by the base (12/2).
2. Insert the lamp (12/3) into the holder (12/1).
3. Press the holder back.
4. Insert the lamp.

Removing the Filter Glass plates

1. Hold the disc holder (13/5).
2. Unscrew the 2 cheese head screws (13/1) and remove the covering plate (13/2).
3. Remove the filter glass (13/4).

Cleaning the Filter Glass plates

1. Clean both filter plates with warm water. A little detergent may be added to the water.
2. Dry the filter plates with a clean cloth.



Warning

The high-pressure lamps must not be used without the filter glass!

1. Insert the cleaned filter plates.
2. Fit the covering glass (13/2).
3. Repeat with the other filter plates.
4. Hook the completely assembled disc holder (12/6) with the cleaned filter plates onto the hook (12/5).
5. Swivel the disc holder towards the canopy.



Function

The lug of the microswitch for the BREAKSAFE fuse is pressed back as you do this.

6. Secure the disc holders with the screws (11/1).

Replacing the Acrylic Sheet

1. Position the acrylic sheet (7/2) into the rail groove (7/3) according to the screen printing.
2. Tilt the acrylic panel towards the canopy.
3. Turn the 4 bolts (7/1) to the vertical position.



Warning

6.2.3 Changing the High-Pressure Lamp in the Shoulder Tanner

Warning!

Hold the high-pressure lamp by the rectangular base (15/2) only.

Never pull the high-pressure lamp by the glass bulb.

Never touch the glass bulb of the high-pressure lamp with your fingers.

If you touch the glass bulb by accident, wipe off the finger prints with a clean cloth soaked in alcohol.

Disassembling the Acrylic Sheet of the Shoulder Tanner

1. Unscrew the screws (14/1).
2. Remove the acrylic panel (14/2).

Raising the Lounge Acrylic

1. Use a screwdriver.
2. Using the screwdriver, press the bolt (3/2) down and turn 90 degrees.
3. Do the same with the second bolt. The lounge acrylic will lift up a little.
3. Holding the lounge acrylic (4/1) by its long front edge, pull forwards approx. 5 cm until the clamping rail engages by its pins (8/3).
5. Lift up the lounge acrylic.
6. Support the lounge acrylic in the center with the rod (4/3).



Function

Removing the High-Pressure Lamp

1. Unscrew the screw (14/7) and dismantle the air distribution cover (14/6).
Ensure that the screws do not fall into the air shaft.
2. Unscrew the screws (14/4) and remove the filter glass plate holder (14/3) upwards.
3. Hold the high-pressure lamp by the rectangular base (15/2).
4. Press the lamp longitudinally into the holder (15/1) until the other side becomes free.
5. Remove the lamp.

Cleaning the Reflectors

Clean the reflector (15/8) with a clean cloth soaked in alcohol.

Replacing the High-Pressure Lamp

1. Hold the new high-pressure lamp (15/6) by the base (15/2).
2. Insert the lamp in the holder (15/1).
3. Press the holder back.
4. Insert the lamp.

Removing the Filter Glass Plates

1. Hold the plate holder (15/5).
2. Remove the blue filter disc (15/4) and the transparent filter plate.

Cleaning the Filter Glass Plates

1. Clean both filter plates with warm water. A little detergent may be added to the water.
2. Dry the filter plates with a clean cloth.

Replacing the Filter Glass Plates

Warning:

When assembling: Blue filter glass nearest the user!

Transparent filter glass nearest the lamp!



Warning

The high-pressure lamps must not be used without the filter glass plates!

1. Insert the cleaned filter plates in the plate holder(15/5) as far as they will go.

Assembling the Shoulder Tanner

1. Insert the plate holder (14/3) from above.
Ensure you do not knock out of place or damage the rubber seal (14/5).
2. Secure the filter glass plate holder (14/3) with the 2 screws (14/4).
3. Secure the air distribution cover (14/6) with 1 screw (14/7).

Lowering the Lounge Acrylic

1. Secure the rod (4/3) in its holder.
2. Lower the lounge acrylic (4/1).
3. Turn the bolts (3/2) back 90 degrees.
4. Push the lounge acrylic back until it engages.

Assembling the Acrylic Sheet of the Shoulder Tanner

1. Replace the acrylic sheet (14/2).
2. Screw in the screws (14/1).

6.3 Changing the Lamps

Burning-in the Lamps

New lamps differ slightly in color, but these differences disappear over time. The lamps are darker at the ends. This is a physical property and not a defect with the lamps.

6.3.1 Changing the Long Sunlamp

Changing the Lamp

1. Remove the appropriate acrylic sheet (see Chapter 6.1).
2. Turn the sunlamp (5/11) in either direction until the contact pins (5/9) can be seen in the slot (5/8) of the lamp holder.
3. Remove the lamp.
4. Clean the reflector (5/3) with a cloth soaked in alcohol.
4. Hold the new sunlamp horizontal so that the contact pins (5/9) are vertically in line.
6. Press the sunlamp into the lamp holder in this position. Turn the sunlamp 90 degrees so that the notch (5/10) in the metal ring at the end of the lamp is at the top. If using a reflector lamp, the lighter reflector side of the lamp must face the unit and the label on the lamp must face the user.
7. Replace the appropriate acrylic sheet.



Function

6.3.2 Changing the Illumination Lamp

• Canopy Illumination Lamp

Removing the Acrylic Sheet

1. Turn the slots in the 4 bolts (7/1) horizontal.
2. Tilt the acrylic sheet(7/2) forwards.
3. Lift the acrylic sheet out of the lower rail groove (7/3).

Changing the Lamp

1. Remove the first two sunlamps behind the front canopy bracket (26/1). The illumination lamp (26/2) is located underneath these sunlamps.
2. Exchange the illumination lamp (see Chapter 6.3.1).
3. Replace the sunlamps.

Replacing the Acrylic Sheet

1. Position the acrylic sheet in the rail groove (7/3) according to the screen printing.
2. Tilt the acrylic sheet(7/2) towards the canopy.
3. Turn the 4 bolts (7/1) to the vertical position.

6.3.3 UWE Light Logo in the lounge

Removing Large Covering Panel in Front of the Base

1. Grip the covering panel (18/8) by the ventilation slots.
2. Remove the covering panel by pulling forwards. The recesses in the covering panel becomes free of the spring clips (18/7).

Replacing the Lamp

The light casing (18/3) with the lamp is beneath the sliding lip.

1. Remove the screws (18/6).
2. Swing the light casing (18/3) down.
3. Withdraw the lamp (18/5) from its holder (18/4) and fit the new lamp into the holder.
4. Re-assemble the light casing.

Replacing the Large Covering Panel in Front of the Base

1. Hook the covering panel (18/8) with its lower slots into the spring clips (18/7).
2. Press the covering panel on completely.



Function

6.4 Changing the Filter Pads

The air used to cool the unit passes through micro-filter pads as it enters the unit. These pads filter out fluff, hair, dust particles etc. to minimise the need for cleaning internal parts such as lamps. The filtered particles clog the pads after long-term use and reduce the cooling effect of the unit, so the filter pads should therefore be replaced from time to time to prevent the unit from overheating. The frequency of replacement depends on the operating time and amount of dirt.

Never wash the filter pads.

Always use original filter pads obtainable from your dealer or PC Marketing.

Check the filter pads after every 200 operating hours.

6.4.1 Filter pads in the Base Casing

Removing Large Covering Panel in Front of the Base

1. Grip the covering panel (18/8) by the ventilation slots.
2. Remove the covering panel by pulling forwards. The recesses in the covering panel becomes free of the spring clips (18/7).

Replacing the Filter Pads

1. Pull the wire clips (18/10) out of the filter frame (18/1).
2. Replace the filter pads (18/11).
3. Reattach the wire clips.

Replacing the Large Covering Panel in Front of the Base

1. Holding of the covering panel (18/8).
2. Insert the bottom flaps of the covering panel into the spring clips (18/7).
3. Press the covering panel on completely.

6.4.2 Filter Pads in the Canopy

Removing the Small Canopy Covering Panel

1. Position the solid rubber suction (31/3) supplied on the small cover panel (31/4).
2. Pull the panel up a little with the suction.
3. Guide the lugs at the back of the small cover panel (31/4) out of the recesses in the large cover panel (31/2).
4. Lift away the small covering panel.

Replacing the Filter Pads

1. Remove the wire clips (31/7) which hold the filter pads (31/6) in place.
2. Insert new filter mat (31/6) according to the shape.
3. Replace the wire clips (31/7).

Replace the small canopy covering panel.

1. Stand in front of the unit.
2. Holding of the small covering panel (31/4).
3. Clip the brackets on the back of the small covering panel into the recesses in the large covering panel (31/2).
4. Lower the covering panel down and insert it into the lugs on the opposite side of the panel.



Warning

6.5 Stay Position in the Support Arms

The canopy cannot be lowered if the stay activates.

Please contact PC Marketing Technical Service if this happens.

7 GENERAL TROUBLESHOOTING GUIDE

Always unplug the unit before you begin servicing and repair work.

Repairs must only be performed out by an authorized technician.

Safety features must not be disassembled or put out of operation.

- **Dark spots at the ends of the lamps**

Dark spots which appear at the ends of the lamps when switched off have no effect on the performance of the tan. Change the starter as a precautionary measure.

- **One or several lamps not lit (change starter)**

Changing the Starter

1. Remove the appropriate acrylic sheet.
2. Check that the lamp is inserted correctly.
3. Check that the starter is inserted correctly.
4. Remove the starter of the lamp (see Table 2) which does not light by turning it counter-clockwise and then reinsert by turning clockwise.
5. If the lamp still does not light, try inserting the starter from a lit lamp.
6. If this does not work, you must check the lamp.
7. Insert the lamp which does not light into a lamp holder where the lamp does light up. If the lamp does not light it is faulty and must be replaced. If it does light up however there is an electric short in the unit.



Function

Inspection by an authorized service technician

	Starter position	Action
Canopy	In back of canopy	Remove covering panel
Side tanner	At bottom of side tanner	Pulling out the Lounge
Lounge	Lamp holder at top of lounge	Remove acrylic sheet
Illumination lamp	At lamp holder	

Table 2

The tanning canopy or tanning lounge becomes too hot

1. Check if the air filters (filter pads) are blocked.
2. With direct air return, ensure that the warmed cooling air is discharged to outside without excessive loss. The air must not be trapped in the hose or in the ventilation duct since this can cause the unit to overheat. The exhaust air hose must not be kinked.

8 LAMP DISPOSAL

Lamp

Fluorescent lamps and high-pressure lamps are hazardous waste. They cannot be disposed of with domestic waste. The local authorities provide information about how to dispose of these lamps.

TECHNICIAN'S SPECIFICATIONS

9 INSTALLING THE UNIT

The unit may only be set up by authorized persons. At least two people are required to set up the unit. The rooms in which the units are set up must be well ventilated otherwise there is a risk of overheating.

9.1 SITE AND DELIVERY LOCATION

The unit is transported and delivered pre-assembled on a pallet. (Exception: the covering panel for the body cooling unit is delivered separately). The unit is firmly secured on the pallet with straps and wrapped in protective wrap. The pallet is unloaded on-site using a hydraulic ramp or fork-lift truck. The unit must be dismantled from the pallet and then reassembled at the installation site. All units are intended solely for tanning indoors. The unit may only be operated in dry rooms and must not be exposed in hazardous areas. The rooms must be well-ventilated.

9.2 Installation and Assembly

Remove the straps and packaging wrap.

9.2.1 Disassembling the Lounge

Removing Large Covering Panel in Front of the Base

1. Grip the covering panel (18/8) by the ventilation slots.
2. Remove the covering panel by pulling forwards. The recesses in the covering panel come free of the spring clips (18/7).

Removing both Filter Frames

1. Turn the slots in the bolts (18/2) horizontal.
2. Hold the filter frame by the handle (18/1).
3. Lift the filter frame with its pilot pins (18/9) out of the holes.
4. Place the filter frame with its pilot pins on the floor.
5. Thread the filter frame downwards and out.
6. Dismantle the second filter frame in the same way.
7. Take both filter frames to the installation site.

Removing the Lounge Acrylic

1. Push up the canopy.
2. Remove the head cushioning and various individual parts, e.g. the fan cowl (23/4).
3. Use a screwdriver.
4. Push the bolt (3/2) down, turning it 90 degrees at the same time.
5. Do the same with the second bolt. The lounge panel moves up a little.
6. Hold the lounge acrylic (3/1) by its front long side.
7. Pull the lounge acrylic and clamping rail (3/3) forward approx. 2 inches until the clamping rail engages.
8. Remove the lounge acrylic and clamping rail.

Pulling out the Lounge

1. Completely unscrew the two screws 6 x 16 (16/2) on the underside of the lounge.
2. Pull out the lounge using the handle (16/3) as far as it will go.
3. Loosen the retaining cord (16/5) on the back of the lounge.

Check that the plug-in connection (20/10) between the lounge and the lounge board (No. 6) is disconnected.

4. Pull out the lounge again and lift up (the lounge should be lifted by two people.)
5. Carry the lounge to the installation site.



Function

9.2.2 Dismantling the Boards and Air Conditioning Unit

Separating the Plug-In Connections

1. Remove the retaining frame (25/3) and holder (25/4) over the cables.
2. Pull the sockets (20/6) from the plugs (20/5).
3. Unscrew the screws (20/3).
4. Remove the holders (20/4) with the plugs (20/5).
5. Pull the plugs (20/18) out of the sockets (20/20) which are fixed on the control board.

Do not disconnect the power cable from the control board (20/1).

6. Separate all other plug connections between the unit and boards.
7. Remove the cable (20/15) from the main processor board (20/16).



Function



Function

Dismantling the Boards and Air Conditioning Unit

1. Remove the retaining frame in front of the air conditioning unit.
2. Remove the air conditioning unit (20/13) a little.
3. Disconnect the 3-pin coupling (20/11) on the air conditioning unit from the coupling (20/12) coming from the terminal in the right-hand base section.
4. Pull the 6 boards (nos. 1-6) and the assembly plate with the main processor board (20/17) from the guide rails.

The power cable (29/5) runs to the exterior via a pressure screw at the rear of the unit.

5. Slacken the retaining clip on the large pressure screw (29/4) at the rear of the unit.
6. Remove the control board (20/1).
7. Pull the main cable through to the interior.
8. Slacken the retaining clip on the small pressure screw (29/3).
9. Pull the coding cable (29/6) through to the interior.

9.2.3 Disassembling the Side Tanner

Removing the Acrylic Sheet

1. Lift up the operating panel (8/1).
The operating panel locks in position.
2. Turn the slots in the 3 bolts (6/1) horizontal.
3. Tilt the acrylic sheet (6/2) forwards onto the long side.
4. Lift the acrylic sheet out of the lower rail groove (6/3).

Disassembling the Side Tanner

1. Remove the sunlamps (30/4) of the side tanner in the area near the body.
2. Dismantle the frame on which the lamp holders are mounted at the bottom of the unit and tilt it inwards.
3. Slacken the 4 screws 8 x 15 (30/2) with washers (30/3) which secure the side tanner to the bracket of the frame holders.
4. Remove the side tanner.

9.2.4 Disassembling the Exhaust Unit

Loosening the Expansion Bellows

1. Loosen the lower spring clips (21/2) of the two bellows (21/1).
2. Push the expansion bellows upwards.

Disassembling the Air Duct

1. Loosen the 3 accessible screws (21/3).
2. Remove the air duct (21/4).

Disassembling the Exhaust Chimney

1. Remove the caps (21/7) and unscrew the screws (21/8) with their inserts (21/9).
2. Carry the exhaust chimney (21/5) to the desired place of installation.

Dismantle the cover plate and guide plates at the rear of the unit.

1. Remove the caps (21/7) and unscrew the screws (21/8) with their inserts.
2. Carry the cover plate (21/10) to the desired place of installation.
3. Dismantle the two guide plates (21/11) for the louvre.

9.2.5 Disassembling the Casing

All the plastic casing sections for the base are secured to the base with EJOT-PT screws 6 x 20 and held together with connecting lugs.

1. Disconnect the yellow cable (22/1) for the shoulder tanner and the fan cable (22/2) from the terminal on the right at the back of the base.
2. Remove the connecting lugs (22/6) and (23/2) from between the casing sections and unscrew the EJOT-PT screws from the base.
2. Remove the casing section with the shoulder tanners (22/3).
3. Remove the casing sections (22/5, 22/7, 23/1, 23/6) from the corners of the base.

9.2.6 Disassembling the Canopy

Removing the Small Canopy Covering Panel

1. Place the solid rubber suction (31/3) supplied on the small covering panel.
2. Pull the panel up a little with the suction.
3. Guide the lugs at the back of the small cover panel (31/4) out of the recesses in the large cover panel (31/2).
4. Lift the cover panel up and away.



Function

Removing the Large Canopy Covering Panel

1. Stand behind the unit.
2. Slacken the 2 screws (31/5).
3. Press the front side of the covering panel and simultaneously tilt upwards until the brackets slip out of the recesses in the light panel (17/16).
4. Remove the covering panel.

Removing the Acrylic Sheet

1. Turn the slots in the 4 bolts (7/1) horizontal.
2. Tilt the acrylic sheet (7/2) forwards.
3. Lift the acrylic sheet out of the lower rail groove (7/3).

Removing the Canopy

Note Some tips for easier canopy removal:

1. Press the canopy down.
2. Push a 7 mm diameter pin (28/8, part no. 260 551) through the recess in the mechanism (28/6) on each side of the retaining arm.



Function

The 2 pins are assembly aids only and must be removed once the canopy is assembled.

Next steps

3. Dismantle the louvre (31/8) together with its mounting rail (31/10).
4. Unscrew the 8 socket head cap screws (28/1), 8 x 20, and washers.
5. Lift up the canopy above the retaining brackets (28/7).
6. Take the canopy to the place of installation.



Function

Avoid damaging the aluminium panel (30/5) if placing the canopy on the floor.

9.2.7 Disassembling the Base

Opening the Base

Note The base casing consists of 2 elements which are held together by screws.

1. Separate the plug connection (25/8, 25/9) between the right and left hand sections of the base.
2. Remove the 6 screws 6.3 x 16 (25/13) with their lock washers (25/14).
3. Take the 2 base sections to the desired place of installation.

Dismantle the retaining arms (if necessary because of space).

1. Remove the fixing screws (25/10, 25/12) that are screwed into the retaining arms at the side and rear.
2. Remove the retaining brackets by lifting upwards.

9.2.8 Installing the Exhaust Unit

Installing the Exhaust Unit

1. Install the exhaust unit (21/5) in the center at the back of the tanning room.

9.2.9 Assembling the Base

Assembling the Base

1. Arrange the two sections of the base in the tanning room as shown in Figure 25.
2. Assemble the base sections with the 6 screws 6.3 x 16 (25/13) and lock washers (25/14).
3. Make the plug-in connection (25/8, 25/9) between the right and left hand sections.

Assembling the Retaining Arms (if disassembled)

1. Take the retaining arms (25/6, 25/11) and guide them into the corresponding recesses in the base from above.
The retaining brackets (25/7) for the side tanner should face inwards.
2. Attach each of the retaining arms from behind using 3 screws M10 x 16 (25/12) and from the side with 4 screws M10 x 10 (25/10).
Make sure to tighten down the short screws at the side so as not to impair the movement of the mechanism.



Function

9.3 Assembling the Casing

The plastic corner sections around the base are secured with EJOT-PT screws 6 x 20 which are screwed in from inside the base.

Ensure that you insert the EJOT-PT screws vertically and screw them in vertically.

1. Fasten the front sections of the casing (22/7, 23/1) to the corners of the base using 4 screws each.
2. Attach the lower rear vertical casing section (23/6) with 5 screws and the upper rear vertical section (22/5) with 6 screws to the corner of the base.
3. Pull the cables of the upper vertical casing sections in through the slot in the right hand base wall.
4. Unscrew the cover plate (23/8).
5. Holding the covering panel (23/4) with the ventilation grille.
6. Attach this covering panel with 5 screws from inside the base.

Note

You will have to reach through the hole in the cover plate (23/8) to fasten 3 of the screws.

7. Connect the lower 3 vertical covering panels with the 2 connecting lugs (23/2).
8. Replace the cover plate (23/8).
9. Lift the covering panel (22/3) with the shoulder tanners.
10. Pull the cables for the shoulder tanner (22/1) and fan (22/2) through the hole in the right hand wall of the base.
11. Connect these cables to the terminal as shown on the wiring diagram.
12. Assemble the covering panel (22/3) to the wall of the base with 5 screws.
13. Connect the upper 3 vertical covering panels with the 2 lugs (22/6).

9.3.1 Assembling the Boards and Air Conditioning Unit

Inserting the Boards

The control board (20/1) has components on both sides.

1. Insert the control board in the left-hand slots. The capacitors and timer (20/19) point to the left.
2. Insert the main power cable (29/5) through the pressure screw (29/4) to the outside of the unit.
3. Tighten the clip on the pressure screw (29/4).
4. Check that the coding cable (29/6) is through the pressure screw (29/3), that the clip is tight and that the coding plug (29/2) is inserted in the socket (29/1) and locked in position.
5. Insert the boards numbered 1 - 6 into the slots according to the numbering from left to right (Figure 20).
The recesses in boards 1-6 must always be at the front lower corner of the board.
6. Insert the board (20/17) with the main processor board into the corresponding slot. The main processor board is on the right.
7. Pull the 29-way connector from the terminal at the rear left hand side of the base through the square opening (20/8) to the front, and fit the plug into the socket on the left hand side of the board (20/17).

Inserting the Air Conditioning Unit

1. Connect the 3-pin coupling (20/11) of the air-conditioning unit with the coupling (20/12) from the terminal in the right hand part of the base.
2. Push the air-conditioning unit into the recess as far as it will go to the rear and to the right up against the rubber seal.
3. Adjust the air conditioning unit with the mounting bracket (20/14).
4. Air conditioning unit connection: Pull the socket (35/9) from the main processor board backwards through the square opening and then forwards at the side of the air conditioning unit. Guide the cable grommet into the recess of cover panel. Connect the plug (35/8) of the air conditioning unit into the socket.
5. Pull the main cable for the air conditioning unit through the pressure screw (34/1) and clamp at the terminal (35/10) in the base.
6. Secure the main cable using the pressure screw (34/1).



Function

9.3.2 Assembling the Canopy

Assemble the Canopy

1. Lift the canopy.
2. Hold the canopy above the retaining arms (28/7).
3. Insert the lugs (28/4) on the retaining arms into the holes (28/2) in the canopy.

Take care not to damage the aluminium rail (30/5)!

4. Insert the four screws 8 x 20 (28/1) on each side.

Ensure that the screws are tight.

5. Check that the canopy is aligned correctly in relation to the side pieces of the lounge. The black brush seal (28/9) of the lounge casing must fit loosely against the canopy casing (on both sides).

If this is not the case, adjust the canopy on the appropriate side.

1. To do this, unscrew the bolts a little (28/1).
2. Using a wrench
 - screw in both threaded bolts M 8 x 25 (28/11) to remove the canopy towards the back of the unit.
 - Unscrew both threaded bolts M 8 x 25 (28/11) to move the canopy towards the front of the unit.
3. Tighten the hexagon nuts M 8 (28/10) on the threaded bolts (28/11).
4. Tighten the 4 fixing bolts (28/1).

Once you have followed the previous mounting suggestion:

1. Press the canopy down.
2. Remove the 2 pins (28/8) that you pushed through the holes in the retaining arm.

Next steps

Inserting the Air Duct

1. Insert the air duct (21/4).
2. Screw in the 3 accessible screws (21/3).

Attaching the Bellows

1. Pull the bellows down (21/1).
2. Attach the bellows to the air ducts using the appropriate spring clips (21/2).

Pull the cables through

1. Pull the canopy cables through and down.
2. Attach the holders (20/4) with the plugs according to their numbering (connector X11 etc.) in the holes in the base using 2 screws each (20/3).
3. Pull the two cables (20/15) of the light panel down into the base through the round 30 cm diameter hole (20/9) in the base and connect them to the main processor board.

Replacing the Acrylic Sheet

1. Position the acrylic sheet (7/2) in the rail groove (7/3) according to the screen printing.
2. Tilt the acrylic sheet towards the canopy.
3. Turn the 3 bolts (7/1) to the vertical position.



Function

9.3.3 Assembling the Side Tanner

Mounting the Side Tanner

The face section of the side tanner must be at the top.

1. Slide the top of the side tanner into the side casing (30/6) until the edge of the side tanner (30/8) is against the bracket (30/7).
2. Swing the bottom of the side tanner to the unit.
3. Lift up the operating panel (30/1).

The operating panel locks in position.

4. Line up the 4 holes in the side tanner with the holes in the 4 brackets. (25/7).
5. Insert the 4 screws 8 x 15 (30/2) and washers (thick washer) from the inside of the tanning area.

Ensure that the screws are tight.

6. If you have dismantled the frame for the lamp holders at the bottom of the unit, replace and secure this now.
7. Insert the side tanner lamps (30/4).
8. Attach the plug with bracket (20/4) with the 2 screws (20/3) in the corresponding hole (connector X13) in the base.
9. Attach the canopy cables (28/3) and the side tanner cable to the base using the cable ties (25/4).

10. Attach the cover (25/3) over the connections.
11. Pull the 2 cables of the interior operating panel through the round hole (20/9) in the base and connect them into the corresponding sockets on the main processor board (20/16).

Replacing the Acrylic Panel

1. Lift up the operating panel (8/1).
2. Position the acrylic panel (6/2) in the rail groove (6/3) according to the screen printing.
3. Move the acrylic sheet back against the side tanner.
4. Turn the bolts (6/1) to the vertical position.

9.3.4 Mounting the Covering Panels in the Canopy, Louvre and Exhaust Chimney Mounting the Louvre

1. The louvre (31/8) is attached to the canopy frame by its mounting rail (31/10) from behind.

Mounting the Cover Plate

1. Mount the cover plate (21/10) to the rear corner casing sections with the inserts (21/9), screws (21/8) and caps (21/7).
2. The two guide lugs (21/11) for the louvre are attached with the inserts (21/9), screws (21/8) and caps (21/7).

Mounting the Exhaust Chimney (21/5)

1. The exhaust chimney (21/5) is mounted with the inserts (21/9), screws (21/8) and caps (21/7).
2. Exhaust chimney plug connection: pull the 4-pin coupling from the main processor board through the square opening backwards into the base housing and connect the plug in the back wall of the unit (leads from the exhaust chimney).

Attaching the Large Canopy Covering Panel (31/2)

1. Stand in front of the unit and lower the canopy.
2. Locate the rear edge of the covering panel in the back grooves in the mounting rail (31/10).
3. Push the covering panel back and guide the lugs on the covering panel into the holes in the light panel (17/16).
4. Place the covering panel on the canopy.
5. Insert the 2 screws (31/5).

Attaching the Small Canopy Covering Panel

1. Stand in front of the unit.
2. Lift the small covering panel (31/4).
3. Clip the lugs at the back of the small covering panel into the holes in the large covering panel (31/2).
4. Swing the covering panel down and locate the lugs on the opposite side.

9.3.5 Attaching the Plug-In Connections

1. Attach all the plug-in connections except for the connection between the lounge and the lounge board (20/10).
2. The plug connections can be found in Table 3.
3. As you make the plug connections, pull them along the front recesses in the boards.

9.3.6 Assembling the Lounge

Installing the Lounge

The edge with the foam padding must be to the front.

1. Pull the socket (20/10) of the lounge board (No. 6) back through the square hole (20/8) in the base.
2. Position the lounge so that its back track is resting on the base.

Warning:

Be careful not to trap the lounge cable. It must drop into the base.

2. Push the whole lounge back by its handle (16/3) a little way (like a drawer).
3. Attach the retaining cord (16/5) to the back of the lounge.
4. Attach the 29-pin cable and plug of the lounge into the socket on the lounge board (20/10).
5. Push the lounge back as far as it will go.
6. Tighten down the 2 screws 6 x 16 (16/2).
7. Check that all plug-in modules are pushed home and that all plug connections have been made.



Warning

Replacing the Lounge Acrylic (16/1)

1. Locate the lounge acrylic with the pins (8/3) on the clamping rail (8/2) into the fixture (8/4).
2. Place the lounge acrylic on the lounge.
3. Turn both bolts (3/2) back 90 degrees.
4. Push the lounge acrylic back until it engages.

Attaching the Filter Frame

1. Hold the filter frame by the handle (18/1).
2. Move the handle under the foam-covered front edge of the lounge.
3. Insert the filter frame with pilot pins (18/9) into the drilled holes in the base.
4. Swing the filter frame and handle towards the base.
5. Turn the bolts (18/2) to the vertical position.
6. Mount the second filter frame in the same way.

Attaching the Large Covering Panel in Front of the Base

1. Lift the covering panel (18/8).
2. Insert the bottom flaps of the covering panel into the spring clips (18/7).
3. Push the covering panel up until the top recesses engage in the spring clips (18/7).

9.4 Connecting the Exhaust

Warm Air Re-circulation

You can close (max.) or open (min.) the exhaust air flap in the exhaust duct (21/5) or select a temperature for inside the unit.

1. Refer to Chapter 5.2



Warning

Warning! Important Information!

The heated air must be extracted from the exhaust duct (21/5) of the unit via a direct air outlet (central exhaust duct). WE recommend the use of the special exhaust chimney for this purpose which is supplied with the unit.

Exhaust Chimney

The air can be extracted directly from the exhaust duct of the unit to the ceiling of the room by a special exhaust chimney (33/1)

The 2 main sections of the exhaust chimney are telescopic so that the height of the exhaust chimney can be adjusted to the height of your unit.

An exhaust hose or cap can be attached to the exhaust chimney using adapters to suit your space requirements.

Attaching the Exhaust Chimney

1. Screw the exhaust chimney onto the exhaust duct (32/3) of the unit.
2. Pull the upper section of the exhaust chimney (32/2) up to suit your ceiling height.
3. Fasten the top of the exhaust chimney to the room wall or ceiling with the screws (32/1).



Warning

Warning, Important Information! Please Read, Danger of Overheating!

If the exhaust air is discharged to the outside via a ventilation shaft, ensure minimum flow resistance inside the shaft. Use a booster fan if required. We advise you to consult your HVAC contractor.

The discharge airflow is approx. 1500 cfm/hour, so the same amount of fresh air must be able to enter into the room at the same rate. You should therefore provide fresh air vents in the room wall providing a total opening cross section of at least 2500 cm².

9.5 Electrical Connection

Warning:

Electrical connections must only be performed by a qualified electrician in accordance with the local wiring codes.



Warning

The unit is not delivered with a power cable for connection. The three-phase current cable must be installed by a licensed electrician. Each unit is supplied with a wiring diagram.

1. The power cable should be attached to an independent circuit breaker to allow the unit to be completely isolated from the main power source.

9.6 Remote Timer Control

Insert the coding plug with the cable into the mating socket with retaining clip, which is situated on the inside of the ballast compartment on the far left top level shelf. This cable forms the connection to the remote timer. The cable has four cores (phase, switched phase, second phase and ground). Therefore the remote control system does not require a separate electrical connection. The remote system must be capable of handling an inductive load of up to 16 amps.

Using the red and black wires within the cable, the unit will operate on most timing systems. The white wire is only used when 220v switching is required. Route the cable toward the back left side of unit through the access opening and cable restrain.

Note Cap off white wire when not in use, it supplies line voltage.

10 INITIAL OPERATION

10.1 Technical Specifications, Dimensions and Lamp Configuration

SILVER BULLET	
Unit Type	7019/87
Power (incl. Air-Cond.)	14,000W
Operating Voltage V	3 Phase – 230V
Fuse rating	
(A)	60
(A)	100 *** SINGLE PHASE***
Weight (lbs.)	1700
Dimensions (in inches)	
Length	95
Width	57
Height (Canopy open)	70
Room Temperature for operation max. 76°F.	
The installation site must have a floor loading capacity of at least 110lbs. Per square foot. And must be level.	

*We reserve the right to make technical changes

* Air Conditioning Unit requires a separate 110V / 60 Hz 15 Amp Circuit

Designation	UV Configuration and Re-lamping Type	
	SILVER BULLET VHR LAMPS	SILVER BULLET VHO LAMPS
Canopy, face - UV	3 x 400 W – HERAEUS P/N BQ 471 Z4 2 X 800 W P/N BQ 880 Z4	3 x 400W – HERAEUS P/N BQ 471 Z4 2 X 800 W P/N BQ 880 Z4
Canopy, body - UV	22 x 160 W VHR COSMOLUX P/N 16180	22 x 160 W VHO COSMOLUX (COS. NO. 16 161)
Side tanner, face - UV	1x 400 W HERAEUS P/N BQ 471 Z4	1x 400 W HERAEUS P/N BQ 471 Z4
Side tanner, body - UV	6 x 160 W VHR COSMOLUX P/N 16180	6 x 160 W VHO COSMOLUX (COS. NO. 16 161)
Lounge - UV	20 x 160 W VHR COSMOLUX P/N 16180	20 x 160 W VHO COSMOLUX (COS. NO. 16 161)
Lounge Logo Light	1 x 7 W	1 x 7 W
Shoulder Tanner – UV	2 x 400 W HERAEUS P/N BQ 47024	2 x 400 W HERAEUS P/N BQ 47024

! Turn off the power to the unit before changing lamps.

RELAMPING INSTRUCTIONS

REPLACEMENT LAMP TYPES

CAUTION: REPLACE ONLY WITH ORIGINAL LAMPS OR FDA APPROVED EQUIVALENT

Sunlamp Covering

The sources of UV light are covered by a panel of 2.5 mm thick acrylic in the canopy and by two acrylic sheets in the lounge. One 4 mm thick (waved form) and one 5 mm thick. The acrylic sheets are frosted on the lamp side except for the lower lounge (waved form) acrylic sheet.

The high pressure lamps are covered by a 3.75 mm thick filter type Interferenz filters (manufacturer's part no. 22010) and a 3.75 mm thick filter type 02932 (manufacturer's part no. 02937011).

All face tanners also have a frosted lens of 2.5 mm thick acrylic sheet. A reflector made of mirror-finish rolled, electronically polished and anodised aluminium is inserted between the lamps and the canopy and lounge support.

11 CUSTOMER SERVICE ADDRESS

PC MARKETING
1040 WILT AVENUE
RIDGEFIELD, NJ 07657

1-800-FAST TAN

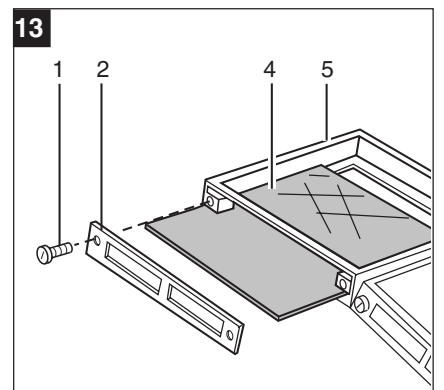
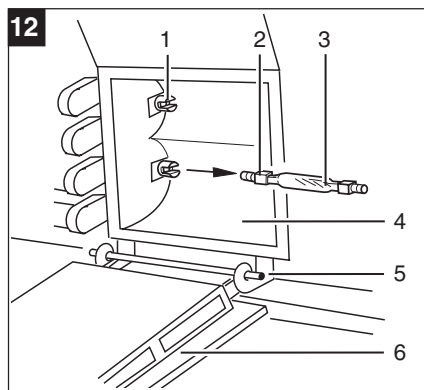
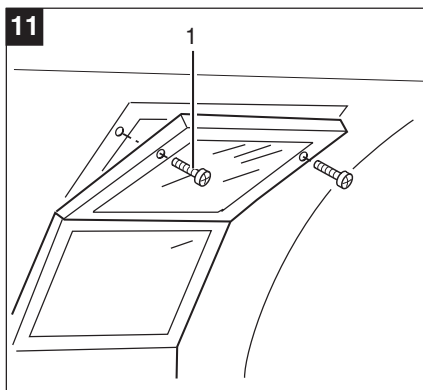
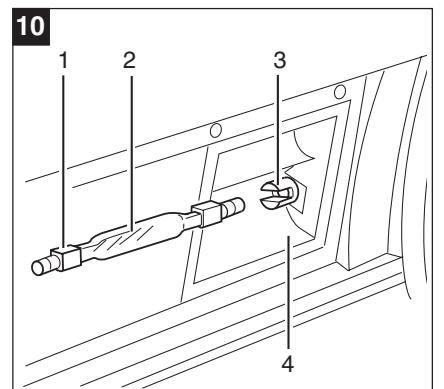
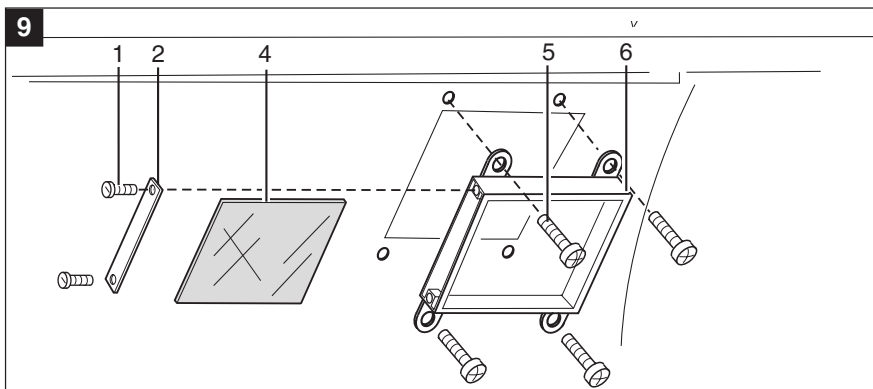
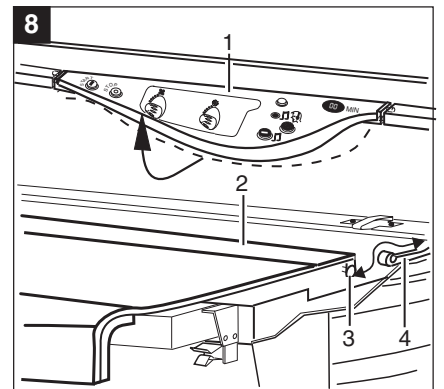
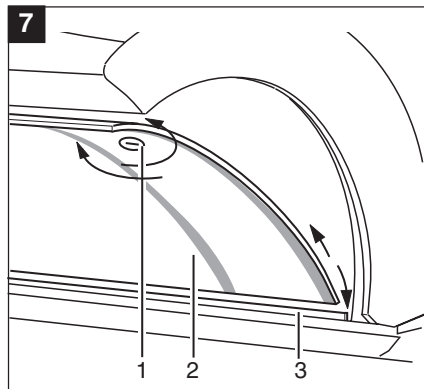
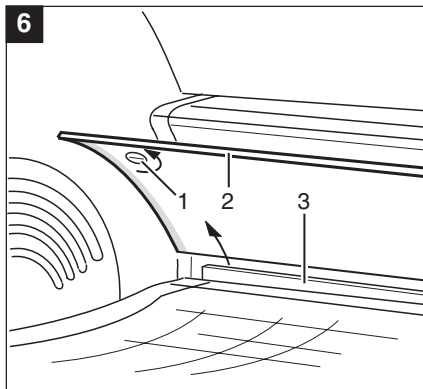
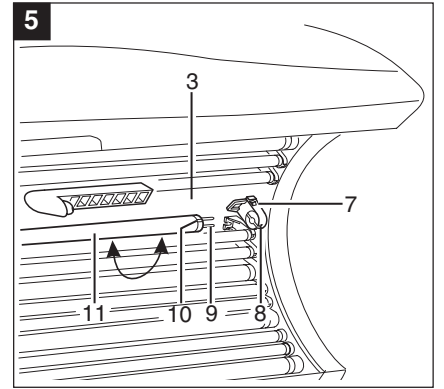
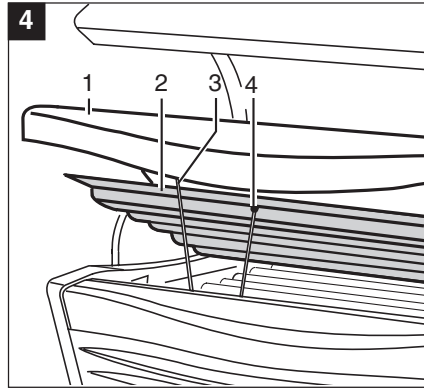
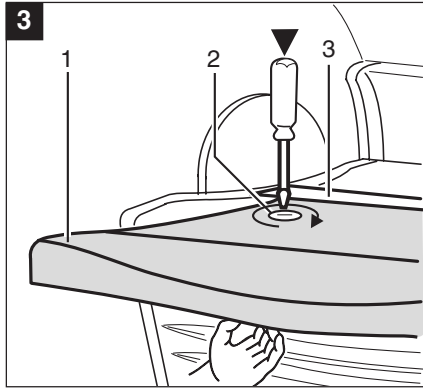
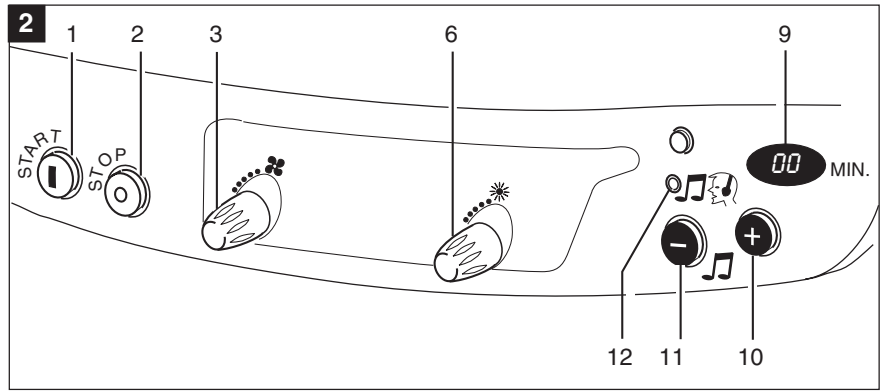
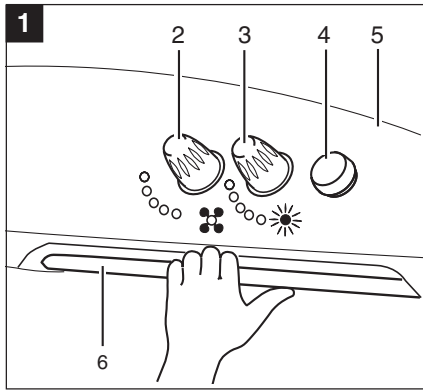

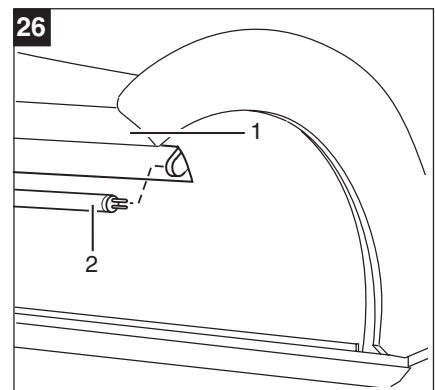
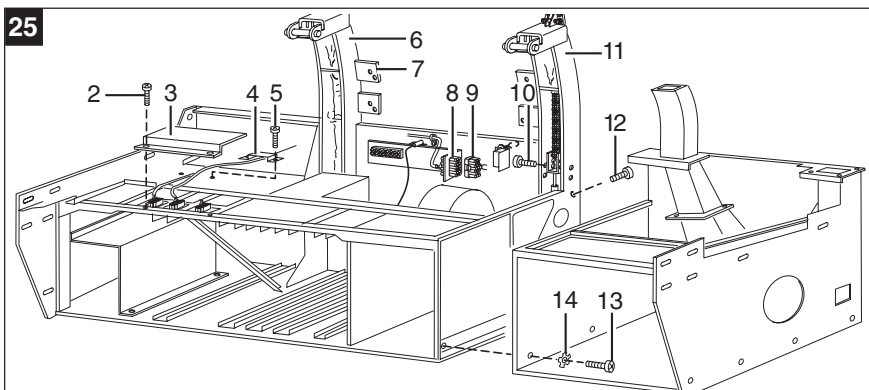
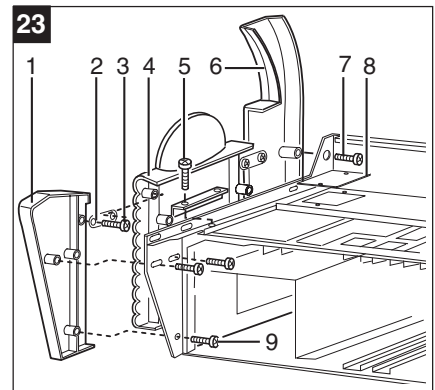
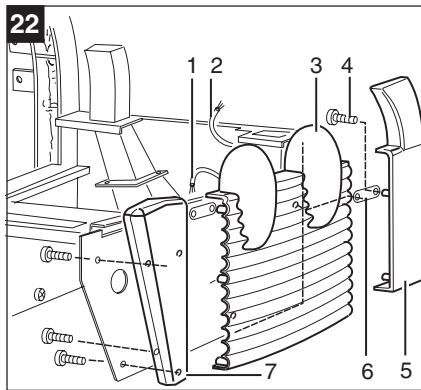
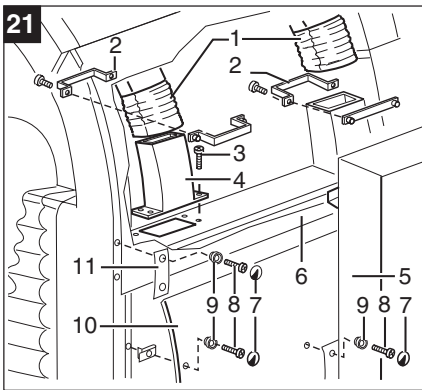
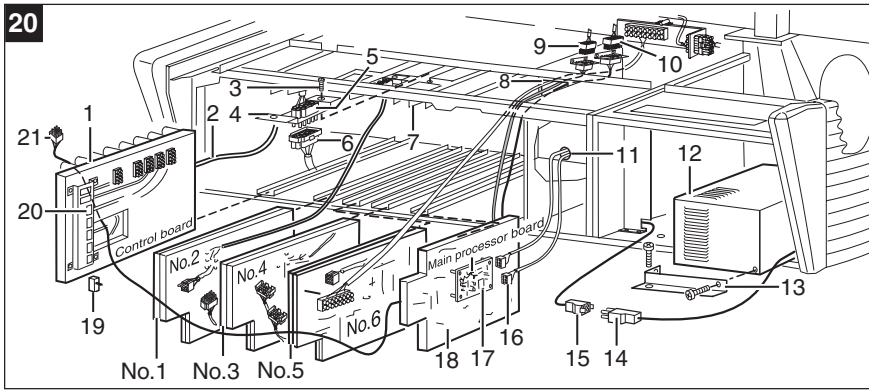
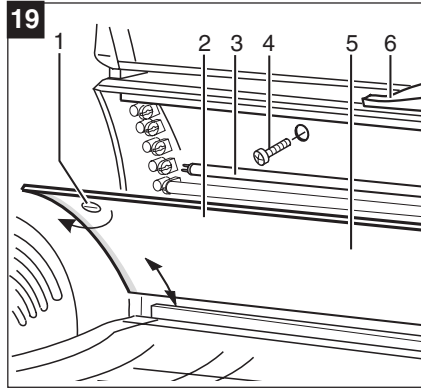
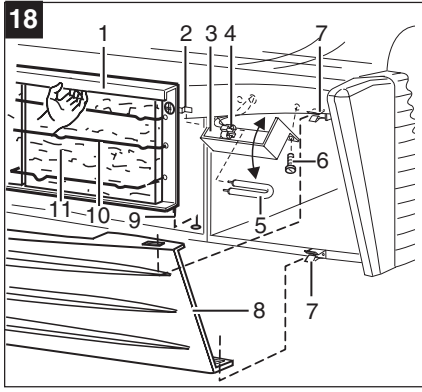
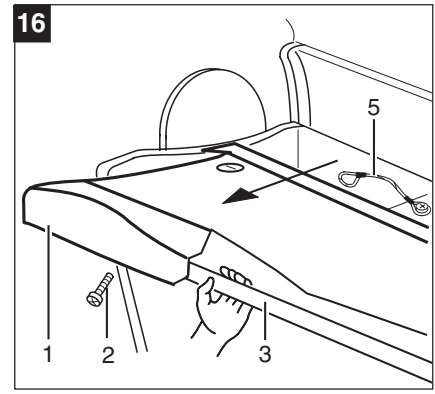
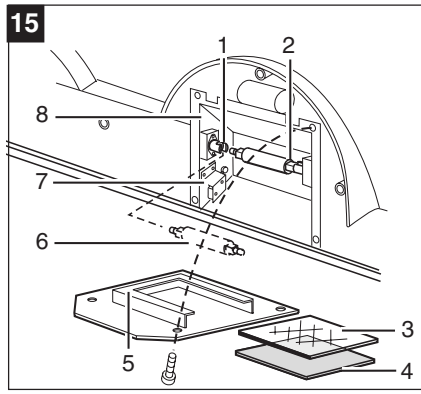
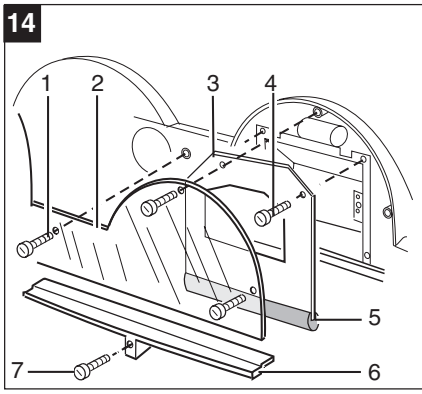

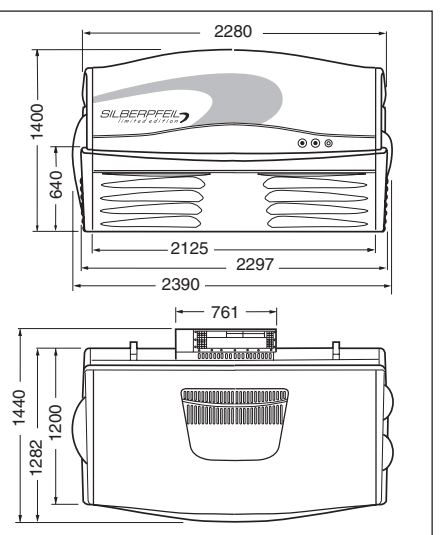
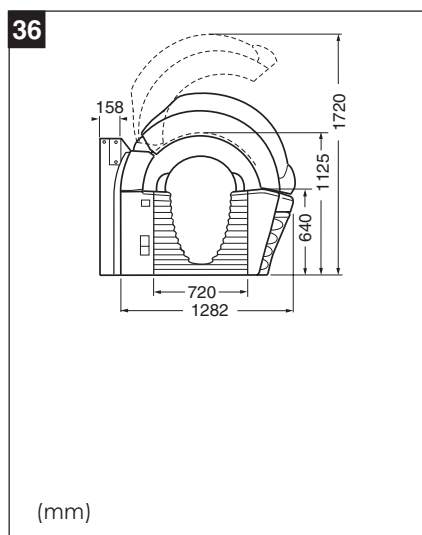
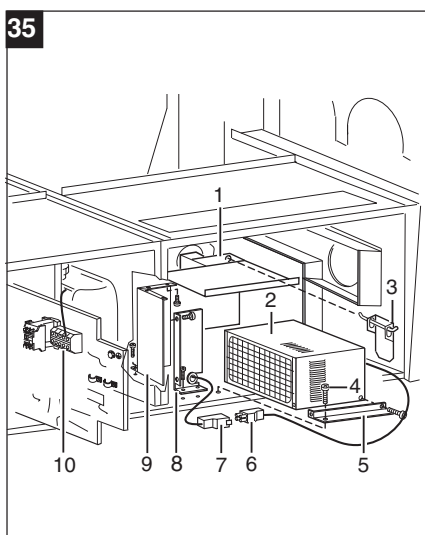
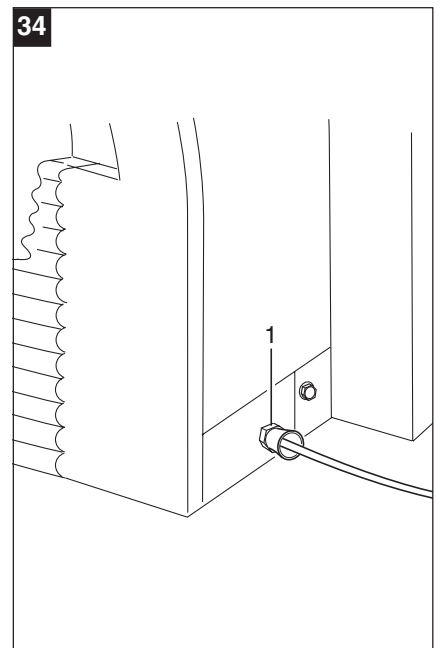
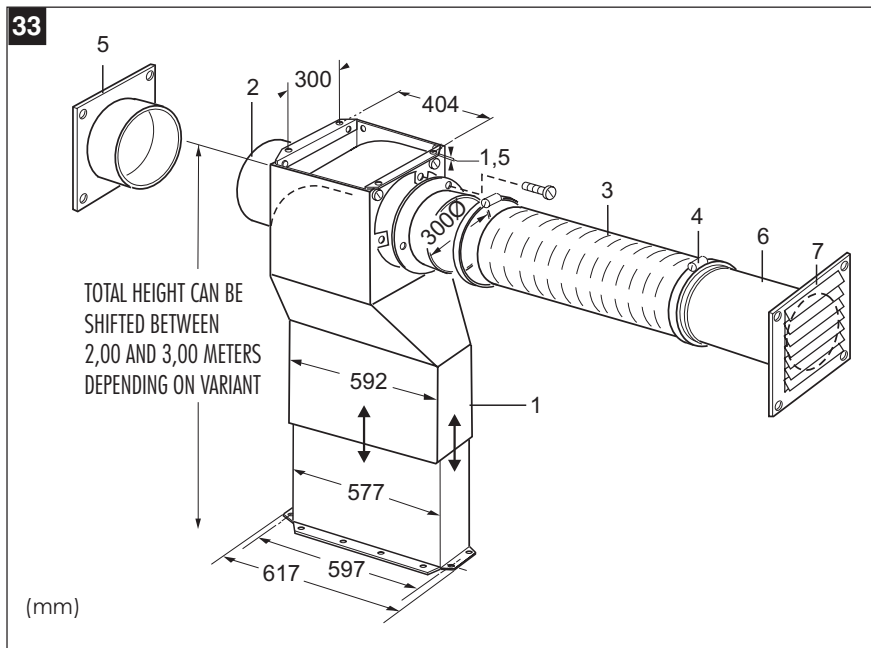
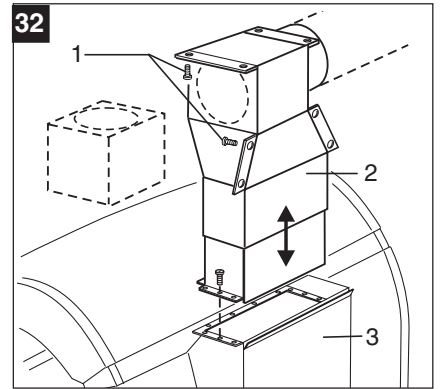
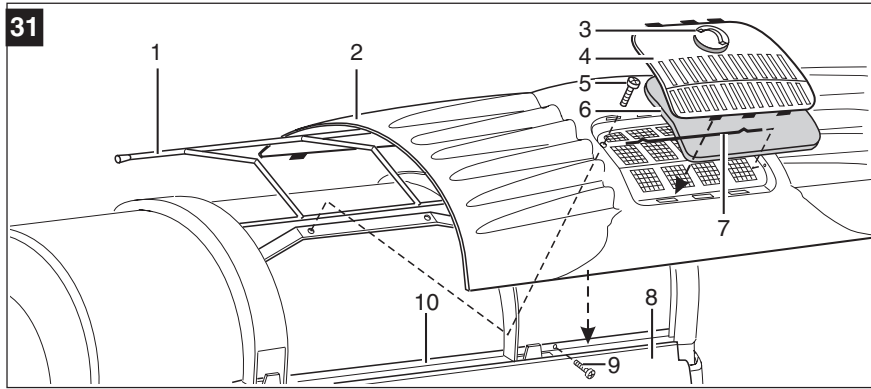
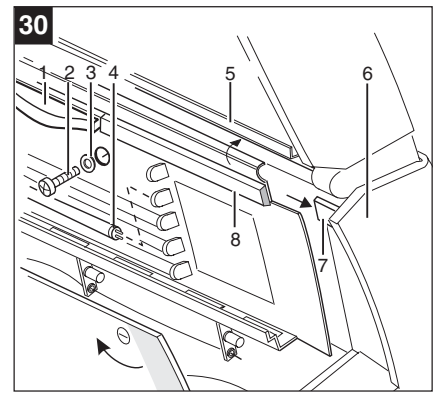
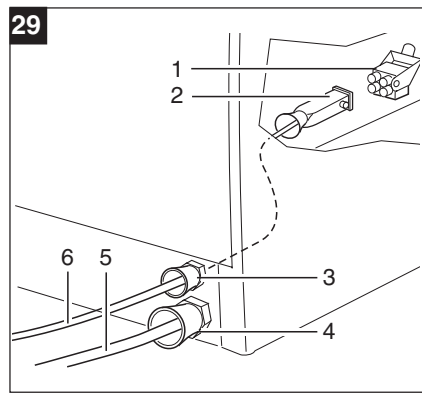
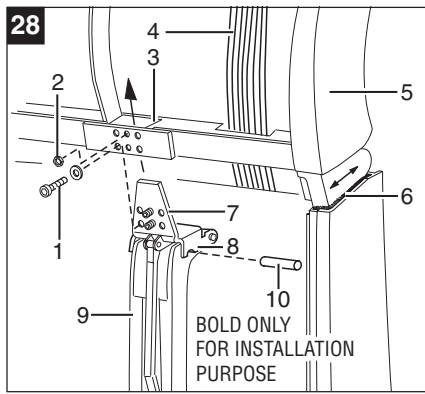

PC MARKETING
1040 WILT AVENUE
RIDGEFIELD, NJ 07657

1-800-FASTTAN



MARKETING

ID.-NR. 262 277 / 01/03